

HENSTRIDGE PARISH COUNCIL

Westcombe House,
48 Bowden Road,
Templecombe,
BA8 0LF

Phone: 01963 370388
Fax by arrangement
Email Rachel at: clerk@henstridgeparishcouncil.org.uk

WE'RE ON THE WEB!
www.henstridgeparishcouncil.org.uk

HAVING YOUR SAY

As always, the Parish Council are keen to receive input from parishioners and would remind you that while a discretionary public forum is held at the beginning of every meeting lawful items for discussion and decision have to be listed on the Parish Council's or Committees' Agendas. Therefore if there is something that you feel the Parish Council should consider, please put your concern or query in writing to the Parish Clerk. Planning meetings (held twice monthly) are open to the public, and public opinion on planning applications is always welcomed either at the meetings or in writing. Copies of meeting Agendas are posted the previous week on the Parish Council's Henstridge & Yenston notice boards.

MEET THE COUNCIL!

The Parish Council in Henstridge is made up of 13 Councillors. Norman Symcox—Chair, HACC Representative
Mickey Vincent—Full Council Vice Chair, Planning and Finance Chair, Yenston and Youth Representative
Adam Temperton—Planning Vice Chair, Footpaths and Play area rep
Paul Brighten—HALT Representative
Pete Crocker—Highways representative
James Day
Chris Everill
Jim Fitch
Geoff Jarvis
David Nicholls
Malcolm Stobart—SALC and VHM Representative
Jean Oswick—VHM Representative
Paul White

Administration for the Council is dealt with by the Clerk and Proper officer, Rachel Walker. In the first instance all queries should be made to the Clerk. The District Councillors are Tim Inglefield and William Wallace, who is also the County Councillor.

The meeting dates for the third quarter of 2009 will be:

FULL COUNCIL:

Monday 9th November
Monday 7th December
Monday 11th January 2010

PLANNING

As above, plus Monday 23rd November
Monday 21st December
Monday 25th January 2010.
Full Council Meetings take place at 7.30 in the Village Hall Lounge. The start times of planning meetings have some flexibility to reflect the number of applications, however they usually begin between 6.45 and 7.15 and times can be confirmed on the notice board, website or by calling the clerk.

HENSTRIDGE PARISH COUNCIL NEWSLETTER

VOLUME 2, ISSUE 2 SEPTEMBER 2009



TRAFFIC CHAOS AT AN END??!

We are all very relieved that the summer of traffic disruption due to the changes to the traffic lights on the A357/A390 crossroads has come to an end. This has caused huge problems for all parts of our Parish, with Yenston being cut off, Bowden becoming a rat run and general chaos ensuing for traffic travelling to and from Henstridge and the Airfield! However, the road has now been re-opened and the lights are up and running so we just now need to wait and see the effects that the new system will have. The Parish Council are very aware that people in the village are unhappy about the replacement of the lights and the introduction of pedestrian crossings, particularly when we have such a dangerous crossing outside

the primary school. Unfortunately the Parish Council were not consulted, or even informed, with regard to the changes. Since questioning the work, we have been advised that the equipment was well past its "use by date", has been updated with some of the latest technology to improve efficiency and save on energy consumption, and that the County Council consider themselves to have approached this in a responsible manner. The Parish Council have passed on concerns with regard to the lack of suitable crossing facilities outside of the school and requested that the crossing be re-marked at the very least. We are also pursuing the introduction of a safety barrier. No response has been received as yet but watch this space for updates!

INSIDE THIS ISSUE:

SKATE PARK	2
PLANNING ENFORCEMENT	2
EXPLORE YOUR SOMERSET ROUTES	3
COUNCIL INFORMATION	4
DATES	4



SKATE AND BIKE FACILITIES—HAVE YOUR SAY AND GET INVOLVED!



The Parish Council have been aware for some time that facilities for older children in the village are somewhat lacking! In recent months we have started looking into the possibility of providing some kind of skate and bike facility in order to satisfy this need—a few of the

ideas we have been given so far can be seen in the illustrations. However! This would be a costly project and will take some time, as funds will need to be found from sources beyond the Parish Council's day to day running costs.

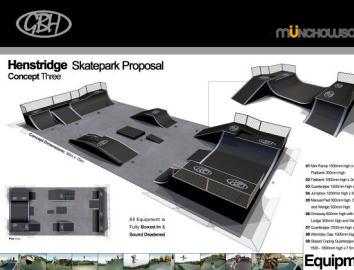

This is where you come in! We want to hear from anybody who would be happy to be involved in working towards achieving the end goal of a skate/bike facility by working on funding etc. We are also keen to hear more from the likely users about what is actually wanted! If you have something to say then please contact the clerk on 370388 or e-mail clerk@henstridgeparishcouncil.org.uk

PLANNING ENFORCEMENT

At the August agenda, it was proposed and agreed that the as the Council are unable to take any direct action for themselves, that the Council's policy for dealing with anonymous calls relating to Planning Enforcement issues, is to provide the informant with the appropriate SSDC contact details and not to take any direct action themselves. Please be aware that if you leave an anonymous message on the Parish Council answer phone then no action will be taken with regard to this. If you have an enforcement matter to report then please contact the Enforcement officer, James Meyer, at South Somerset District Council on 01935 462462.

EXPLORE YOUR SOMERSET ROUTES

Where in the world could you find a Bake-lite coffin, the oldest manmade road in Britain, the largest collection of Naval aircraft in Europe or early Victorian prosthetic limbs?

created which, for the first times gives information and contact details about all the major heritage sites in the county. Get them while stocks last though because this is a one-off print run of 5000 copies! The booklet details each suggested stop and includes a website link where possible. And there's a useful tip or nugget of information with every entry.

You might be surprised to find out the answer is Somerset.

The exhibition will tour across the county over the next year and if you don't manage to see it there are plenty of other ways to find out about Somerset's Heritage. All the information relating to it, including the touring map and itineraries are available at the download at

For a county with a history as rich and diverse as its countryside, Somerset boasts an amazing number of museums and heritage attractions. Explore your Somerset Routes is a unique touring exhibition which highlights over 100 of the counties best heritage sites to visit.

www.visitsomerset.co.uk/touring-map.

Created by Somerset County Council and the Museums in Somerset group the exhibition celebrates the most fascinating, quirky, important and breathtaking sights in the county.

Taster videos are available at

www.youtube.com/somersetmuseums

which shows details of all the sites.

Taking the form of a 'tube map', the county has been broken down into seven different

For more information contact Natalie Watson, Museum Development Officer on 01823 362849 .

lines to travel on, spread across the country and taking in the best sights and things to do. Each line takes you to the museums, historic railways, castles, gardens, stately homes and archaeological sites that make Somerset's heritage unique.

Along with the map, a free booklet has been

